

GENERAL TOLERANCE	
X. ± 0.50	X. ° ± 5°
. X ± 0.20	. X ° ± 2°
. X X ± 0.10	. X X ° ± 1°
DATE:2019/11/19	SBZ

單位 (UNIT)	料號 (PART NO.)	圖號 (DWG NO.)	名稱 (TITLE)
mm	WA1251-R0XX-00TA	WA1251-R0XX	IO PARTS Enterprise Co., Ltd.
審核 (APPROVAL)	檢核 (CHECKED)	繪圖 (DRAWN)	名稱 (TITLE):
Alice	Mary	Fen-Fen	Pitch: 1.25mm Wire To Board
			Water / Right Angle Dip Type

Recommended P.C. Board Hole Layout

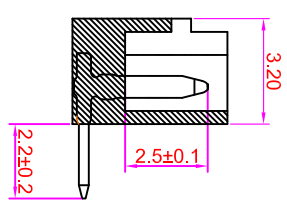
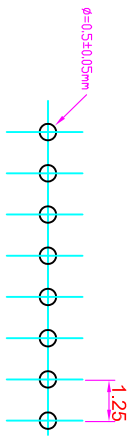

Order Information

WA1251 - R 0 XX - 0 0 XX

Serial Type _____

Terminal Type _____

R: Right Angle Type

No. of Contacts _____

02 ~ 15

Contact Plating _____

TA : Tin Plated

Poles	Dimensions			Poles	Dimensions		
	A	B	C		A	B	C
02	1.25	3.15	4.25	09	10.00	11.90	13.00
03	2.50	4.40	5.50	10	11.25	13.15	14.25
04	3.75	5.65	6.75	11	12.50	14.40	15.50
05	5.00	6.90	8.00	12	13.75	15.65	16.75
06	6.25	8.15	9.25	13	15.00	17.90	18.00
07	7.50	9.40	10.50	14	16.25	18.15	19.25
08	8.75	10.65	11.75	15	17.50	19.40	20.50

Rev	Modification Content	Date	Validate

MATERIAL:

WAFER: HIGH TEMPERATURE PLASTIC NYLON46 UL94V-0
 PIN: HIGH STRENGTH BRASS
 WITH TIN OVER NICKEL PLATED

SPECIFICATION:

CURRENT RATE: 1 AMP
 INSULATION RESISTANCE: 500 MΩ MIN
 Contact Resistance: 20m Ω max.
 DIELECTRIC VOLTAGE: 500 V AC FOR ONE MINUTE
 OPERATION TEMPERATURE: -25°C ~ +85°C

