

Recommended

P.C. BoardHole Layout

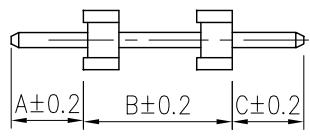
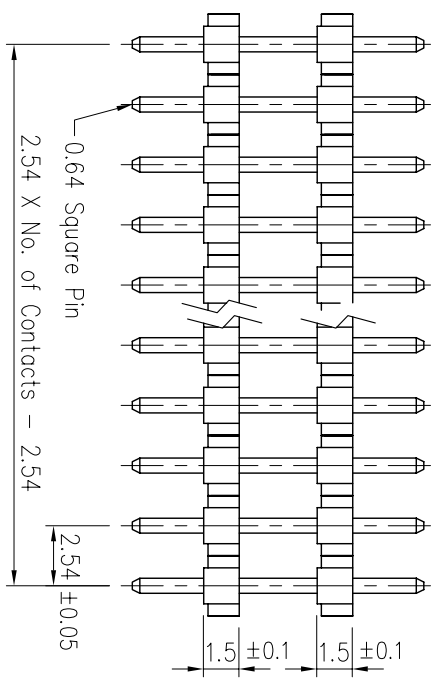
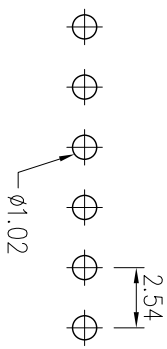

Specifications

- Current Rating : 3 Amps
- Insulator Resistance : 1000 Megohms min.
- Contact Resistance : 20 m ohms max.
- Dielectric Withstanding : AC 600V
- Operating Temperature : -40°C ~ +105°C
- Contact Material : Brass
- Insulator Material : Polyester, UL 94V-0
- Standard : P.B.T
- Contact Plated : Full Gold, Full Tin, Selective Plated

Order Information

PHAB - S 1 XX - 0 X XX
 Serial Type Terminal Type S : Straight Type
 Row Type 1 : Single Row
 No. of Pin per Row _____
 Terminal Dim. _____
 1. A=.....B=.....C=.....
 2. A=.....B=.....C=.....
 3. A=.....B=.....C=.....
 Contact Plating _____

Contact Plating Option	Full Gold Plating	Gold Plating On Contact Area Tin Plating On Solder Area	Full Tin Plating
GA : Gold Flash GC : Gold 10u" GD : Gold 15u" GE : Gold 30u"	SA : Gold Flash SC : Gold 10u" SD : Gold 15u" SE : Gold 30u"	TA : Tin 100u"	

GENERAL TOLERANCE		單位 (UNIT)	料號 (PART NO.)	圖號 (DWG NO.)	廠 名 稱 宏 允 企 業 有 限 公 司 多 稱 (TITLE) : Pin Header P2.54mm H:1.5mm Single Row, Dual Body, Straight Type
X . ± 0.50	X . ± 5 .	mm	PHAB-S1XX-0XXX	PHAB-S1XX	
. X ± 0.20	. X ± 2 .		檢 封 (CHECKED)	比 例 (SCALE)	
. X X ± 0.10	. X X ± 1 .		Mary	3 : 1	張 數 (SHEET)
日期 (DATE)	2007/05/15		Fen-Fen	角 法 (PROJ.)	1 / 1
				圖 樣 (REV.)	1.0