

ROHS

Recommended P.C. Board Hole Layout

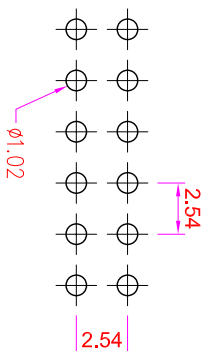

- Specifications**
- Current Rating : 3 Amps
 - Insulator Resistance : 1000 Megohms min.
 - Contact Resistance : 20 m ohms max.
 - Dielectric Withstanding : AC 600V
 - Operating Temperature : -40°C ~ +125°C
 - Contact Material : Brass
 - Insulator Material : Polyester, UL 94V-0 Nylon-6T
 - Contact Plated : See Option
 - Standard: Full Gold Flash

Order Information

PHA2 - S 2 XX - XX XX

Serial Type

Terminal Type

S : Straight Type

Row Type

2 : Dual Row

No. of Pin per Row

Terminal Dim.

- 01. A=3.0mm, C=6.0mm (Standard)
- 02. A=3.43mm, C=2.67mm

Contact Plating

Full Gold Plating	Gold Plating On Contact Area Tin Plating On Solder Area	Full Tin Plating
Contact Plating Option		
GA : Gold Flash GC : Gold 10u" GD : Gold 15u" GE : Gold 30u"	SA : Gold Flash SC : Gold 10u" SD : Gold 15u" SE : Gold 30u"	TA : Tin 100u"

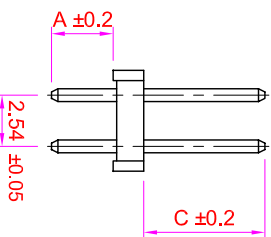
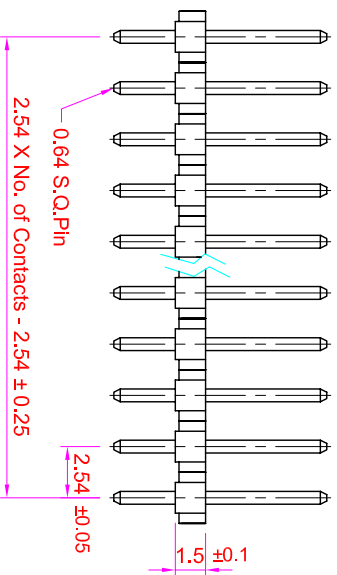

GENERAL TOLERANCE

X. ± 0.50	X. ° ± 5°
.X ± 0.20	.X ° ± 2°
.XX ± 0.10	.XX ° ± 1°
DATE:2008/03/05	SSV2

單位 (UNIT)

料號 (PART NO.) PHA2-S2XX-XXXX

審核 (APPROVAL)

核對 (CHECKED)

製圖 (DRAWN)

Alice

Mary

Fen-Fen

圖號 (DWG NO.)

PH A2-S2XX

比例 (SCALE)

張數 (SHEET)

3:1

1/1

名稱 (TITLE):

允企業有限公司 IO PARTS Enterprise Co., Ltd.

Pin Header P2.54 X 2.54mm

H:1.5mm, Dual Row, Straight Type

J 1 2 3 4 5 6 7 8 9 10 11 12