

ROHS

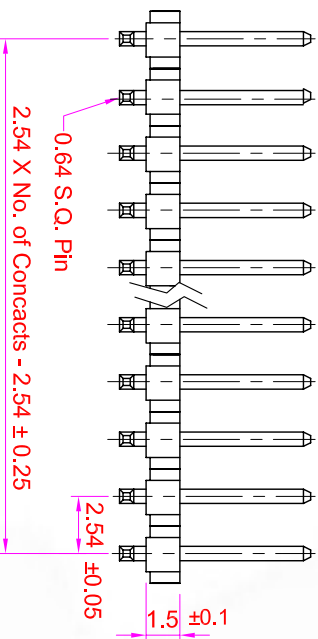

Recommended P.C. Board SMD Layout

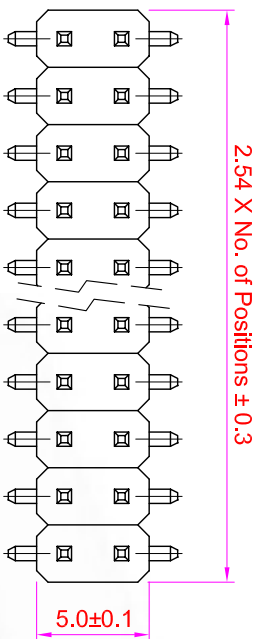
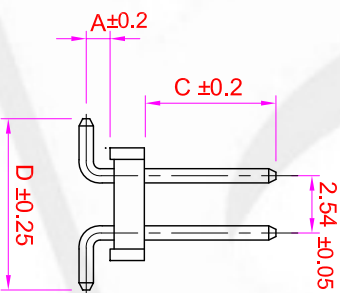
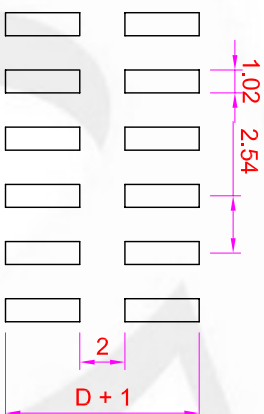

Rev	Modification	Date	Validate

Specifications

- Current Rating : 3 Amps
- Insulator Resistance : 1000 Megohms min.
- Contact Resistance : 20 m ohms max.
- Dielectric Withstanding : AC 600V
- Operating Temperature : -40° C ~ +105° C
- Contact Material : Brass
- Insulator Material : Polyester, UL 94V-0 Nylon-6T
- Contact Plated : See Option
- Standard: Full Gold Flash

Order Information

- PHA2 - M 2 XX - X XX XX - X X
- Serial Type
 - Terminal Type
M : SMD Type
 - Row Type
2 : Dual Row
 - No. of Pin Per Row
 - Post Option
0: Without Post
1: With Post
 - Terminal Dim.
1. A=..., C=..., D=...
2. A=..., C=..., D=...
3. A=..., C=..., D=...
 - Contact Plating
 - Cap Option
B : Blank (No Cap)
P : Plastic Cap
 - Packing Method
T : In Tube
R : Tape & Reel

Contact Plating Option	Full Gold Plating	Gold Plating On Contact Area Tin Plating On Solder Area	Full Tin Plating
GA : Gold Flash GD : Gold 10u" GE : Gold 15u" GF : Gold 30u"	SA : Gold Flash SD : Gold 10u" SE : Gold 15u" SF : Gold 30u"	TA : Tin 100u"	

GENERAL TOLERANCE		單位 (UNIT)		料號 (PART NO.)		圖號 (DWG NO.)		圖號 (DWG NO.)		名稱 (TITLE):	
X ± 0.50	X ° ± 5 °	mm	mm	PHA2-M2XX-XXXX	PHA2-M2XX	3:1	1/1				
.X ± 0.20	.X ° ± 2 °	Alice	Alice	Mary	Fen-Fen	SCALE	SHEET				
.X X ± 0.10	.X X ° ± 1 °										
DATE:2008/03/05	SSVZ										

IO PARTS 允企業有限公司
IO PARTS Enterprise Co., Ltd.

Pin Header Pitch: 2.54 X 2.54mm
H: 1.5mm, Dual Row, SMD Type