

ROHS

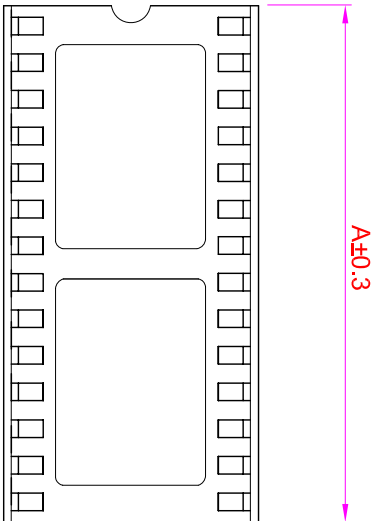

**Recommended
P.C. Board Hole Layout**

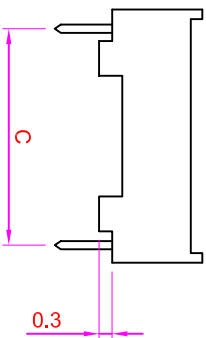
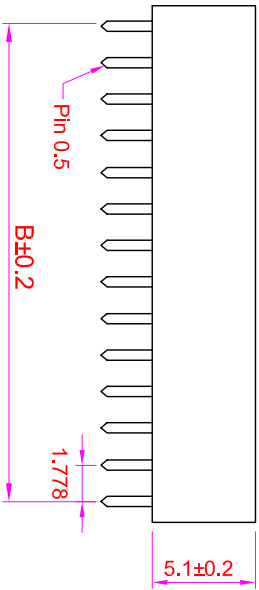
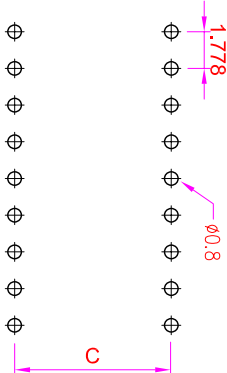

- Specifications**
- Current Rating : 1 Amp
 - Insulator Resistance : 1000 Megohms min.
 - Contact Resistance : 15 m ohms max.
 - Operating Temperature : -40°C ~ +105°C
 - Contact Material : Phosphor Bronze
 - Insulator Material : Polyester, UL 94V-0 P.B.T
 - Contact Plated : Tin Plating

Order Information

- IC~~S2~~ - ~~XX~~ - ~~XX~~ ~~TA~~
- Serial No. _____
 - No. of Contact _____
24P~64P
 - Spacing _____
4:0.4" (10.16mm)
24P .28P .30P
6:0.6" (15.24mm)
40P .42P .52P .56P
7:0.75" (19.05mm)
64P
 - Bar option _____
1:W/ Bar (From 24P to 64P)
 - Contact Plated _____
TA: Tin Plating

| Pin No. | A | B | C |
|---------|-------|-------|-------|
| 24 | 21.34 | 19.56 | 10.16 |
| 28 | 24.89 | 23.11 | |
| 30 | 26.67 | 24.83 | |
| 40 | 35.60 | 33.78 | 15.27 |
| 42 | 37.34 | 35.56 | |
| 52 | 46.23 | 44.45 | |
| 56 | 49.78 | 48.01 | 19.05 |
| 64 | 56.90 | 55.12 | |

| GENERAL TOLERANCE | | 單位 (UNIT) | | 料號 (PART NO.) | | 圖號 (DWG NO.) | | 名稱 (TITLE) | |
|-------------------|-------------|-----------|-------|---|----------------------|--------------|--------|---|--|
| X. ± 0.50 | X. ° ± 5° | mm | mm | IC S2 - XX - XX TA | IC S2 -0X | 比例 3:1 | 張數 1/1 | 允允企業有限公司 IO PARTS Enterprise Co., Ltd. | |
| .X X ± 0.20 | .X X ° ± 2° | Alice | Alice | IC S2 - XX - XX TA | Fen-Fen | 圖法 | SHEET | IC Socket P1.778mm Straight Dip Type | |
| .X X ± 0.10 | .X X ° ± 1° | Mary | Mary | IC S2 - XX - XX TA | Fen-Fen | 公差 | REV. | | |
| DATE:2010/06/04 | SHZ | | | | | PROL. | B | | |