

1 2 3 4 5 6 7 8 9 10 11 12

Rev	Modification	Date	Validate

Recommended P.C. Board Hole Layout

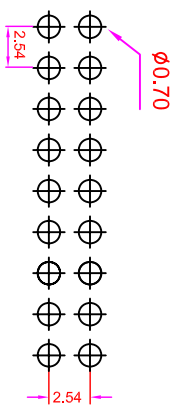
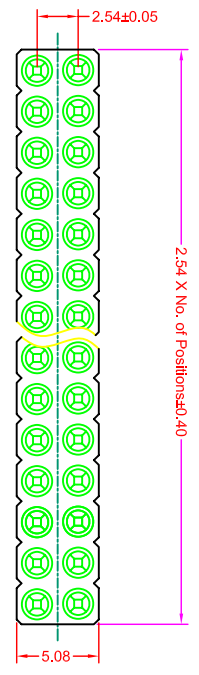

Material:
Pin(outer sleeve): Brass,machined CuZn38Pb2
Plating(outer sleeve):
Tin plated:2um/80u" Ni, 5um/200u" Sn
Gold Plated:2um/80u" Ni,Full gold
Insulator(Black): Glass filled thermoplastic polyester UL94V-0

Electrical:
Current rating: 3Amps/contact max.
Contact resistance: $\leq 4m\Omega$ /contact
Insulation resistance: $\geq 1000M\Omega$ at V=100V
Operating voltage: 60VAC/DC

Mechanical:
Operating temperatures: Gold Plated:-55 C to+125 C
Tin plated:-40 C to+105 C

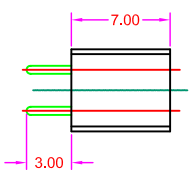
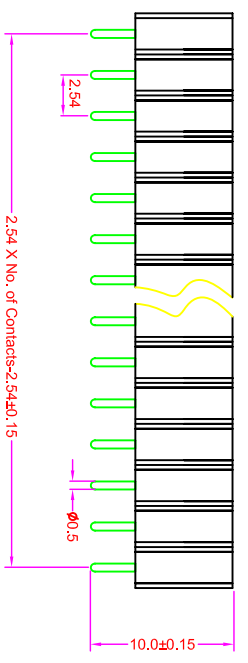

MHA1 - S 2 XX - T2 GA

Serial No. _____

Row Type _____
S: Straight Type

Row Type _____
2: Dual Row

No. of Contact _____
02PIN - 40PIN

Pin Plating Option _____
T2: Tin plating 200u"

Clip Plating Option _____
GA:Gold Flash

GENERAL TOLERANCE		單位 (UNIT)		料號 (PART NO.)		圖號 (DWG NO.)		名稱 (TITLE)	
X. ± 0.50	X. ° ± 5°	mm	mm	MHA1-S2XX-XXGA	MHA1-S2XX	Free	1/1	埃允企業有限公司 IO PARTS Enterprise Co., Ltd.	
.X ± 0.20	.X ° ± 2°	審核 (APPROVAL)		校對 (CHECKED)	製圖 (DRAWN)	比例 (SCALE)	圖號 (REV.)	Pitch 2.54 Female Header H:7.0mm Machine Round Pin / Dual Row	
.X.X ± 0.10	.X.X ° ± 1°	Alice	Mary	Fen-Fen	Free	REV.	A		
DATE:20090305	SOM								

J I H G F E D C B A