

ROHS

Recommended P.C. Board Hole Layout

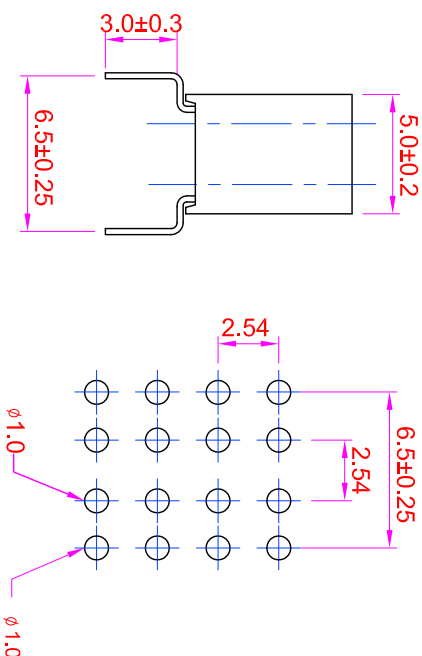
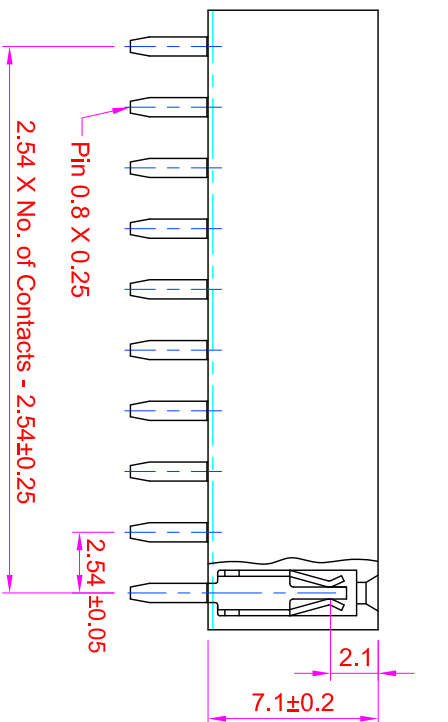
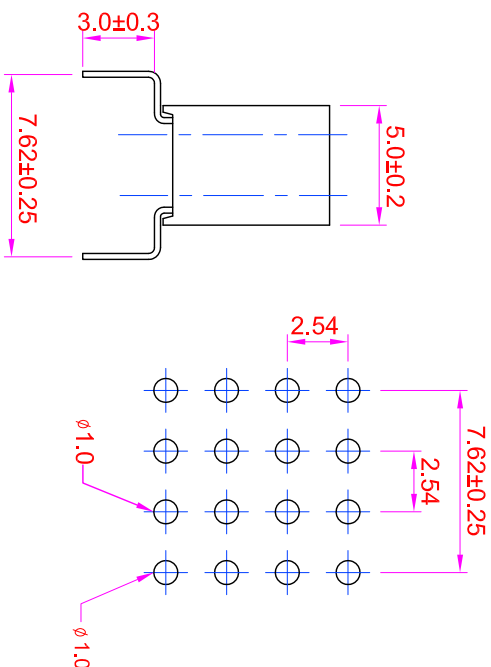
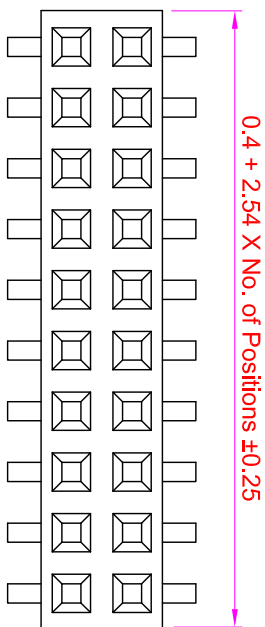

Specifications

- Current Rating : 3 Amps
- Insulator Resistance : 1000 Megohms min.
- Contact Resistance : 20 m ohms max.
- Dielectric Withstanding : AC 600V
- Operating Temperature : -40°C ~ +125°C
- Contact Material : Phosphor Bronze
- Insulator Material : Polyester, UL 94V-0 Nylon-9T
- Contact Plated : See Option
- Standard: Full Gold Flash

Order Information

FHAJ - S 2 XX - 0 X XX

- Serial No. _____
- Terminal Type _____
- S : Straight Type
- Row Type _____
- 2 : Dual Row
- No. of Contact Per Row _____
- Pin Type _____
- 2: D=6.50mm
- 3: D=7.62mm
- Contact Plated _____

Contact Plating Option	Full Gold Plating	Gold Plating On Contact Area Tin Plating On Solder Area	Full Tin Plating
	GA : Gold Flash GC : Gold 10u" GD : Gold 15u" GE : Gold 30u"	SA : Gold Flash SC : Gold 10u" SD : Gold 15u" SE : Gold 30u"	TA : Tin 100u"

GENERAL TOLERANCE		單位 (UNIT)		料號 (PART NO.)		圖號 (DWG NO.)	
X. ± 0.50	X. ° ± 5°	mm		FHAJ-S2XX-0XXX		FHAJ-S2XX	
.X ± 0.20	.X ° ± 2°	審核 (APPROVAL)		檢驗 (CHECKED)		比例 (SCALE)	
.XX ± 0.10	.XX ° ± 1°	Alice		Mary		3:1	
DATE:2010/1/05	SCM1	Fen-Fen		Fen-Fen		張數 (SHEET)	
		SCM1		A		1/1	
				名稱 (TITLE): Female Header P:2.54 x 2.54 mm			
				Profile : 7.1mm, Bottom Entry Type, Dual Row			

玖允企業有限公司
IO PARTS Enterprise Co., Ltd.