

**ROHS**

**Recommended  
P.C. Board Hole Layout**

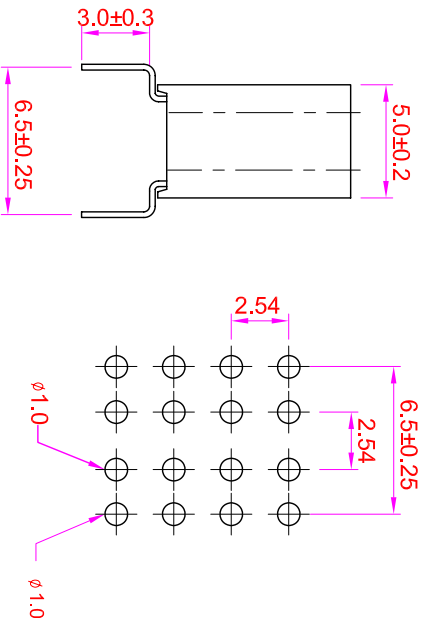
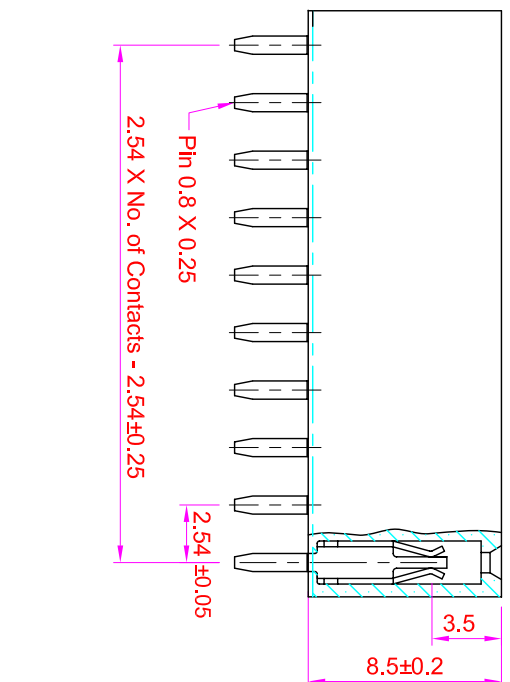
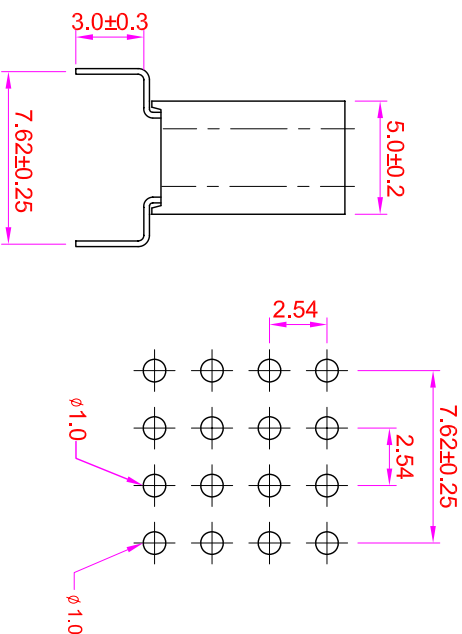
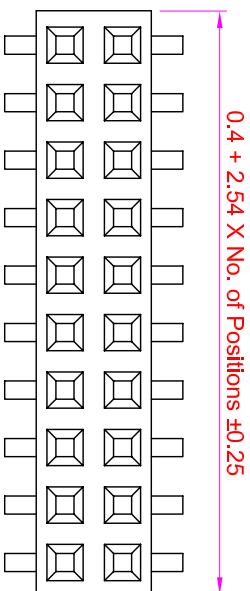

**Specifications**  
 Current Rating : 3 Amps  
 Insulator Resistance : 1000 Megohms min.  
 Contact Resistance : 20 m ohms max.  
 Dielectric Withstanding : AC 600V  
 Operating Temperature : -40°C ~ +105°C  
 Contact Material : Phosphor Bronze  
 Insulator Material : Polyester, UL 94V-0 Nylon-6T  
 Contact Plated : See Option  
 Standard: Full Gold Flash

**Order Information**

**FHAI - S 2 XX - 0 X XX**

Serial No. \_\_\_\_\_  
 Terminal Type \_\_\_\_\_  
 S : Straight Type  
 Row Type \_\_\_\_\_  
 2 : Dual Row  
 No. of Contact Per Row \_\_\_\_\_  
 Pin Type \_\_\_\_\_  
 2: D=6.50mm  
 3: D=7.62mm  
 Contact Plated \_\_\_\_\_

Contact Plating Option	Full Gold Plating	Gold Plating On Contact Area Tin Plating On Solder Area	Full Tin Plating
GA : Gold Flash GC : Gold 10u" GD : Gold 15u" GE : Gold 30u"	SA : Gold Flash SC : Gold 10u" SD : Gold 15u" SE : Gold 30u"	TA : Tin 100u"	

GENERAL TOLERANCE		單位 (UNIT)		料號 (PART NO.)		圖號 (DWG NO.)		名稱 (TITLE)	
X. ± 0.50	X. ° ± 5°	mm		FHAI-S2XX-0XXX		FHAI-S2XX		宏允企業有限公司 IO PARTS Enterprise Co., Ltd.	
. X ± 0.20	. X ° ± 2°	審核 (APPROVAL)		校對 (CHECKED)		比例 (SCALE)		Female Header P:2.54 x 2.54 mm	
. X X ± 0.10	. X X ° ± 1°	Alice		Mary		3:1		Profile : 8.5mm, Bottom Entry Type, Dual Row	
DATE:20/01/105	SCM1	Fen-Fen		Fen-Fen		角法 (PROJ.)			