

ROHS

Recommended
P.C. Board Hole Layout

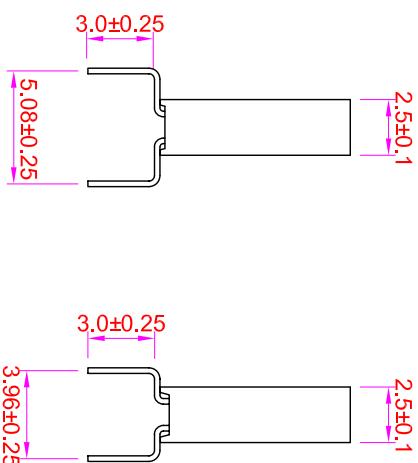
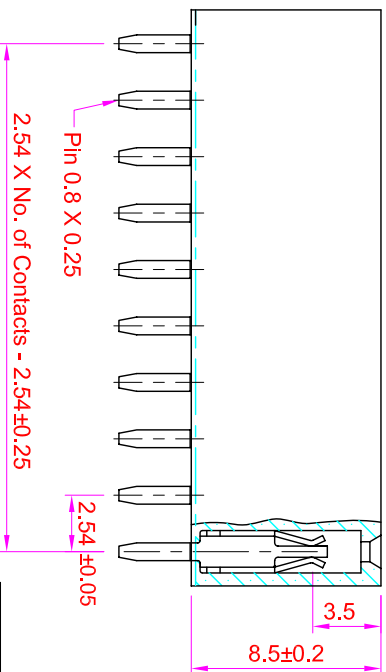
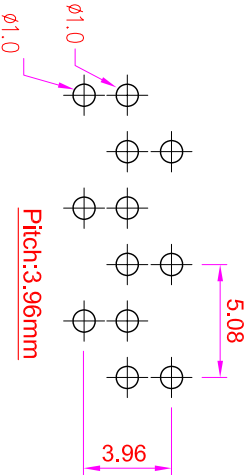
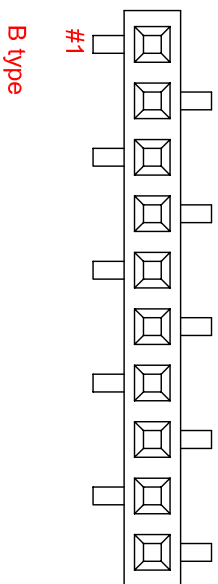
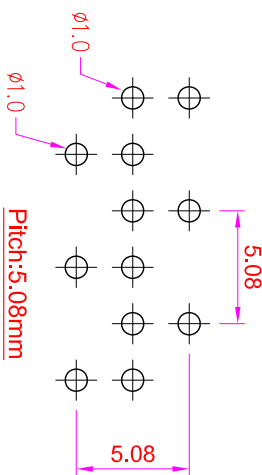
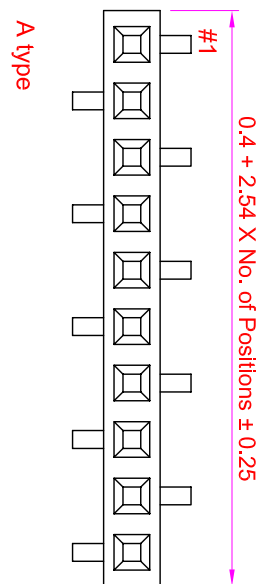

- Specifications**
- Current Rating : 3 Amps
 - Insulator Resistance : 1000 Megohms min.
 - Contact Resistance : 20 m ohms max.
 - Dielectric Withstanding : AC 600V
 - Operating Temperature : -40°C ~ +105°C
 - Contact Material : Phosphor Bronze
 - Insulator Material : Polyester, UL 94V-0 Nylon-6T
 - Contact Plated : See Option
- Standard: Full Gold Flash

Order Information

FHAI - S 1 XX - X X XX

- Serial No. _____
- Terminal Type _____
- S : Straight Type
- Row Type _____
- 1 : Single Row
- No. of Contact Per Row _____
- Pin Layout Type _____
- A: A-Type
- B: B Type

- Pin Type _____
- 2: D=3.96mm
- 3: D=5.08mm

Contact Plated _____

Contact Plating Option	Full Gold Plating	Gold Plating On Contact Area Tin Plating On Solder Area	Full Tin Plating
GA : Gold Flash GO : Gold 100" GD : Gold 150" GE : Gold 300"	SA : Gold Flash SO : Gold 100" SD : Gold 150" SE : Gold 300"	TA : Tin 100u"	

GENERAL TOLERANCE		單位 (UNIT)	料號 (PART NO.)	圖號 (DWG NO.)
X. ± 0.50	X. ° ± 5°	mm	FHAI-S1XX-XXXX	FHAI-S1XX
.X ± 0.20	.X ° ± 2°			
.XX ± 0.10	.XX ° ± 1°			
DATE:2010/11/05	SCM1			
		審核 (APPROVAL)	料號 (CHECKED)	製圖 (DRAWN)
		Alice	Mary	Fen-Fen
		比例 (SCALE)	縮放 (REV.)	張數 (SHEET)
		3:1	A	1/1
		名稱 (TITLE):	IO PARTS Enterprise Co., Ltd.	
		Profile : 8.5mm, Bottom Entry Type ,Single Row		

IO PARTS Enterprise Co., Ltd.

IO PARTS Enterprise Co., Ltd.

Female Header P:2.54 X 2.54 mm

Profile : 8.5mm, Bottom Entry Type ,Single Row